

Clarke®



GUN SAFE WITH DIGITAL LOCK

MODEL NO: CGS5D, CGS8D

PART NO: 7724029, 7724032

OPERATION & MAINTENANCE INSTRUCTIONS



ORIGINAL INSTRUCTIONS

LS0519

INTRODUCTION

Thank you for purchasing this CLARKE Gun Safe with Digital Lock.

Before attempting to use this product, please read this manual thoroughly and follow the instructions carefully. In doing so you will ensure the safety of yourself and that of others around you and you can look forward to your purchase giving you long and satisfactory service.

GUARANTEE

This product is guaranteed against faulty manufacture for a period of 12 months from the date of purchase. Please keep your receipt which will be required as proof of purchase.

This guarantee is invalid if the product is found to have been abused or tampered with in any way, or not used for the purpose for which it was intended.

Faulty goods should be returned to their place of purchase, no product can be returned to us without prior permission.

This guarantee does not effect your statutory rights.

CARTON CONTENTS

The following items should be supplied in the carton. If any parts are missing or damaged, please see your Clarke dealer.

1 x Gun Safe
2 x Gun Safe Override Keys
2 x Ammunition Safe Keys
2 x Expansion Bolts
4 x AA Batteries

PART IDENTIFICATION



INSTALLATION

Remove everything from the box and dispose of any packaging materials in an environmentally friendly way.

FIXING THE GUN SAFE IN POSITION

1. Your gun safe must be securely fixed to the structure of the building.
 - Ideally it must be in a room or space that does not have direct access to the outside of the building.
 - It must not be in a garage, shed or other outbuilding.
 - When considering the larger or heavier gun safes, you should consider the load bearing strength of your floors.
 - Wherever possible, it should be fixed to either a wall that is built from bricks or concrete blocks or to the floor. If this is not possible then to a strong joist using suitable fixings.
 - The gun safe must be out of sight. If it is in a corner, it is more difficult for a thief to attack it.
 - You should avoid fixing the gun safe near any heat source.
2. The gun safe must be secured using suitable fixings.
 - There are two fixing holes on the rear and four on the bottom.
3. Fit the gun safe flush to the wall.
 - If needed remove the skirting boards behind/to the side of the gun safe as they may leave a large enough gaps for a crowbar to be used to prise the gun safe away.

NOTE: IF YOU HAVE ANY QUERIES CONTACT YOUR LOCAL FIREARMS LICENCING TEAM.

KEYS

1. Remember it is YOUR responsibility to ensure that unauthorised persons can not gain access to your guns.
 - Do not let anyone (including family members) know the combination or where the override keys are kept. You may lose your shotgun/firearm certificate if you do.
2. Keep the keys to the gun safe in a place where they can't be found easily.
 - "hiding" keys in a drawer is pretty obvious to a thief, so think carefully about the hiding place. Consider purchasing a small combination safe where only you know the combination.

BEFORE USE

OPENING THE SAFE FOR THE FIRST TIME

1. Remove the override key cover from the front panel.
2. Insert the override key, turn it clockwise as far as possible and hold it in position.
3. At the same time, turn the keypad lock anticlockwise as far as possible and hold it in this position.
4. Release the override key
5. Push the main handle down and pull the door towards you to open the safe.

IMPORTANT: Never keep the override keys inside the safe itself.

6. Remove the key and replace the override key cover onto the front panel.

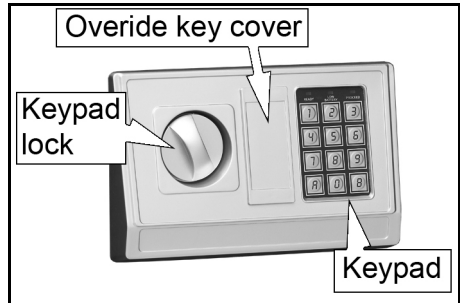

INSTALLING THE BATTERIES

The safe requires 4 x size "AA" (1.5V) batteries.

1. Open the safe.
2. Remove the battery cover plate on the back of the door and install the batteries.
 - Ensure the batteries are fitted with the correct polarity.
3. Use of alkaline batteries is recommended.

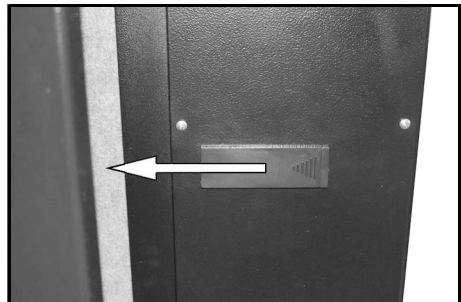

PROGRAMMING THE CODE

NOTE: You have approximately 5 seconds to carry out each step before the lock resets and you need to start again.

1. With the safe door open and the batteries installed: Press the code reset button (A) on the rear of the door once.

- You will hear a beep.
- The yellow light will be displayed on the keypad.

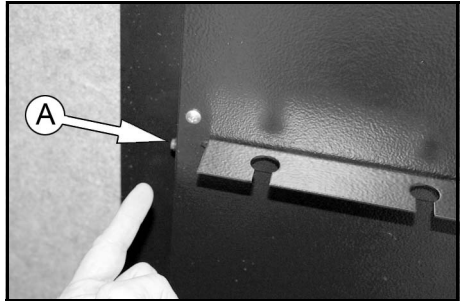

2. Enter the code you want to use (3-8 digits) as a combination.
3. Press "A" or "B" to confirm your code.
 - The safe "beeps" once and the yellow light will go off,
 - Your personal code is now set.
4. Test the safe using the new combination immediately.



USING YOUR SAFE

TO OPEN THE SAFE

1. Enter your personal code followed by the letter "A" or "B".
 - you will hear a beep and the green light on the front of the safe will light up.
2. Turn the keypad lock anticlockwise as far as possible and hold it in this position.
3. Push the handle down and pull the door towards you.
 - If you, or an intruder uses the incorrect group of numbers, it will not open, if the incorrect combination is used 3 times, you must wait for 18 seconds before trying again.
 - If the incorrect combination is selected a further 3 times, you must wait approximately 4.5 minutes before trying again.

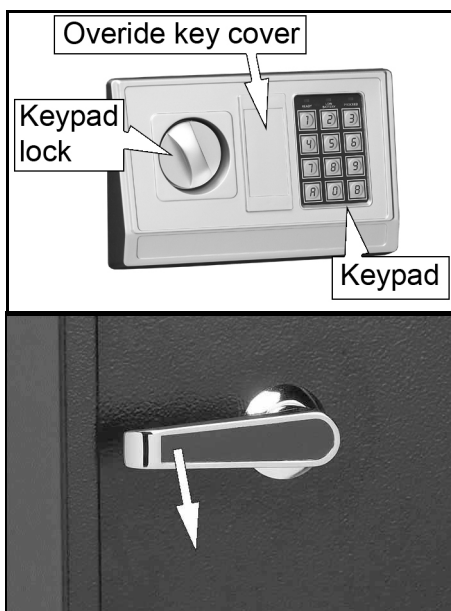

INSERT THE GUNS

1. Remove all ammunition from the guns and secure the ammunition in the ammunition safe.
2. Place the guns into the gun safe making sure they are resting securely against the foam inserts.



THE AMMUNITION SAFE

Inside the gun safe is a small ammunition safe.

Use the key supplied to access this compartment.



CLOSING THE GUN SAFE

1. Close the door and lift the handle up.
2. Turn the keypad lock clockwise as far as possible to lock the safe.

BATTERY REPLACEMENT WARNING

If the batteries are low, the red light on the keypad will illuminate. Replace the batteries immediately.

MANUAL OVERRIDE

See "Opening the safe for the first time" on page 5.

MAINTENANCE AND SERVICING

There are no user serviceable parts in this gun safe. Any repairs must be carried out by Clarke service (see bottom of the page for contact number)

CLEANING

Wipe the surfaces with a damp cloth. Do not use harsh cleaners as they may damage the finish of your gun safe.

REPLACEMENT OVERRIDE KEY

A small label is located on the door of each safe with a key number.

This number must be registered with Clarke international in the event you may require a replacement key.

Please complete the registration form supplied and send it to the address stated with the form.

If you fail to register the safe we will not be able to provide you with a replacement key.

We recommend that in addition to sending the completed form you remove the label from the safe and fix it to the space below. Please retain this document for future reference.

Fix or record the key number here

Key Number.....

SPECIFICATIONS

Model Number		CGS5D	CGS8D
Part Number		7724029	7724032
External Dimensions (W x D x H)	(mm)	350 x 340 x 1450	490 x 360 x 1450
Fixing Hole diameter	(mm)	10	10
Capacity		5 Guns	8 Guns
Maximum Gun Length	(mm)	1260	1260
Ammunition Box Dimensions	(mm)	340 x 145 x 185	480 x 155 x 190
Wall thickness	(mm)	4	4
Weight (Empty)	(kg)	53	61.5

A SELECTION FROM THE VAST RANGE OF

Clarke®

QUALITY PRODUCTS

AIR COMPRESSORS

From DIY to industrial, Plus air tools, spray guns and accessories.

GENERATORS

Prime duty or emergency standby for business, home and leisure.

POWER WASHERS

Hot and cold, electric and engine driven - we have what you need

WELDERS

Mig, Arc, Tig and Spot. From DIY to auto/industrial.

METALWORKING

Drills, grinders and saws for DIY and professional use.

WOODWORKING

Saws, sanders, lathes, mortisers and dust extraction.

HYDRAULICS

Cranes, body repair kits, transmission jacks for all types of workshop use.

WATER PUMPS

Submersible, electric and engine driven for DIY, agriculture and industry.

POWERTOOLS

Angle grinders, cordless drill sets, saws and sanders.

STARTERS/CHARGERS

All sizes for car and commercial use.



PARTS & SERVICE: 0208 988 7400

E-mail: Parts@clarkeinternational.com or Service@clarkeinternational.com

SALES: UK 01992 565333 or Export 00 44 (0)1992 565335

Clarke® INTERNATIONAL Hemnall Street, Epping, Essex CM16 4LG
www.clarkeinternational.com